



VERTICAL TRANSFER SYSTEM SELECTION GUIDE

Create competitiveness for your logistics system



2016 V1.0

Damon
Damon Simplifies Logistics

Intensive use of land and green environmental protection is becoming the basic requirements on logistic and storage center construction, more and more logistic centers has gradually shifted the development from the original “ expansion” mode to multi-layer and higher level ones. Vertical Transfer equipment has become the critical equipment in multi-layer logistic center. Damon Group, as the leader of conveying and sorting equipment in China logistic industry has firstly found the changes in market demand and imported the advanced technology from Japan.

Vertical Transfer equipment is the specially-used equipment which is able to make a precise and fast commodity delivery to the appointed destination through the combination of vertical and horizontal conveying methods controlled by automation.



It meets the vertical conveying demands for pallet, caged trolley, carton, single pieced items and some other special items and it has been widely used in multi-layers conveying in workshop, logistic storage distribution centers in various kinds of industry. It is featured with high-efficiency, high-safety, easy operation and maintenance, etc.





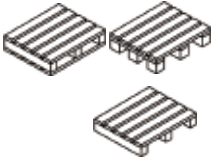
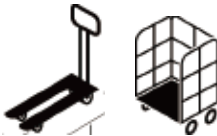

Watch the product introduction
by scanning the code

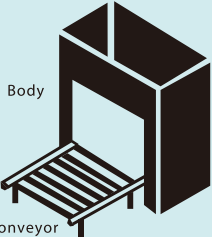

Catalogue

Items Model	Efficiency	Speed Range	Conveying Items	Weight Range	Conveying path	Page
AEW Reciprocating Vertical Lifter	Approx 90 pieces /hr	15,35,65,90 m/min	 <p>Pallets</p>	15-2000kg	Multiple-in & Multiple-out between many floors	4-8
AENW Reciprocating Vertical Lifter	Approx 70 pieces /hr		 <p>Hydraulic forklift & selecting cage trolley</p>	15-1500kg	Multiple-in & Multiple-out between many floors (Recycling Transfer)	10-21
AEEW Reciprocating Vertical Lifter	Approx 120 pieces /hr					
VEF-Z Continuous Vertical Lifter	Approx 1800 Pieces /hr	15,20,25,30 m/min	 <p>Carton, Container, small sized bag</p>	0.5-100kg	One input & one output between two different floors	22-26
VEF-C Continuous Vertical Lifter		15,20,25 m/min				

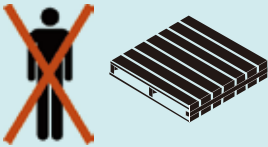
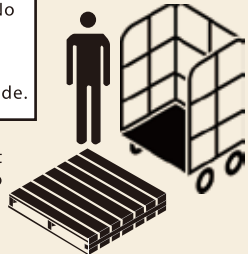
■ Distinctions between Vertical Lifter & Cargo Elevator

Vertical Lifter	Comparison Items	Cargo Elevator
<div data-bbox="193 584 504 739"> <ul style="list-style-type: none"> ① Automatic assistant conveyor: Yes ② Upper Machine Room: No ③ Lower part pit: No ④ Elevator Shaft Road: No ⑤ Height Limitation: Yes </div> <div data-bbox="512 562 724 799">  <p>Body</p> <p>Automatic assistant conveyor</p> </div> <p>Need Setting Space of body and automatic assistant conveyor before the body</p> <p>※Conveying height of setting floor is low where requires a lowerpart pit.Elevator Shaft Road: Some of types require Elevator Shaft Road.</p>	<p>Setting Space</p>	<div data-bbox="879 584 1190 739"> <ul style="list-style-type: none"> ① Automatic assistant conveyor: Yes ② Upper Machine Room: No ③ Lower part pit: No ④ Elevator Shaft Road: No ⑤ Height Limitation: Yes </div> <div data-bbox="1246 584 1369 918">  <p>Machine Room</p> </div> <p>Need space for Elevatorshaft Road</p> <p>※The upper Machine Room requires over two times space of level of elevator shaft projected area.</p>
<div data-bbox="193 1028 504 1149"> <ul style="list-style-type: none"> ① Stipulation on Dimension: Yes ② Stipulation on Shape: Yes ③ Stipulation on Weight: Yes ④ Operator: Not allowed to take ride </div> <div data-bbox="520 1112 703 1159"> <p>Square cases,Plastic Containers Bags</p> </div> <p>Bottom items, such as plastic container, so, the conveying items has the limitation.</p> <p>Personnel not allowed to take ride.</p> <div data-bbox="459 1181 727 1328">  </div>	<p>Stipulation On Handling Items</p>	<div data-bbox="879 1028 1190 1149"> <ul style="list-style-type: none"> ① Stipulation on Dimension: No ② Stipulation on Shape: No ③ Stipulation on Weight: Yes ④ Operator: Allowed to take ride. </div> <div data-bbox="1158 1041 1406 1295">  </div> <p>※Operator can take ride on it and pallet, cage trolley can also be handled.</p>
<div data-bbox="193 1438 448 1580"> <ul style="list-style-type: none"> ① destination floor Set-up. ② Press start Button. ③ Put conveying items on the automatic assistant conveyor. </div> <p>Need figure bottom items, such as plastic container, So, the conveying items has the limitation.</p> <p>Personnel not allowed to take ride.</p> <div data-bbox="280 1608 671 1737">  </div>	<p>How To Use</p>	<div data-bbox="879 1425 1190 1651"> <ul style="list-style-type: none"> ① Press call-out button ② Entry door open ③ Move the cargo in ④ Press destination floor button ⑤ Entry door close ⑥ Movement of lift up and down ⑦ Entry door open ⑧ Move the cargo out </div> <div data-bbox="1238 1435 1374 1629">  </div> <p>Same with common cargo elevator, the whole process is operated by one operator.</p> <p>※Call-out ,door's open & close, move in and out of cargo, lifting up & down, Need to spend time for each procedures.</p>

Safety Design

To guarantee operator's safety and protect the conveying item and equipment, there are various kinds of abnormal condition detective device to be installed on the equipment for customer's easy use.

Brief Introduction on control

Accident Prevention Equipment

- Equipped with safety fence to prevent any entrance of automatic Assistant conveyors.
※ Painting color is same with conveyor frame color, it can be specially designed for customer.
- Control cabinet/panel device to be installed before and upper the entrance prevention fence. Stop button, Interphone and signal light are standard devices in case of emergency, In addition to using lights to notice the running/abnormality/full load cases, the warning and notification will also comes from buzzer and various kinds of safety device makes customer's easy in use.
※ Photoeye indicators can be installed on the upper part of cutout as per customer's requirement.
- Control cabinet/panel device has the angle adjustable functions which is able to move the operating screen to the position which is easy in checking.
※ Stainless steel frame might be used in Special environment(Lower Temperature, Cleaning, explosion-proof).
※ Additionally, press-button type might also be applicable.

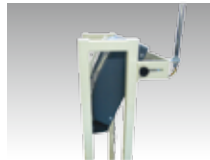
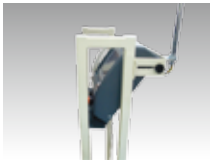

Graphic 65°

Graphic 55°

- Control panel utilize easy distinguishing and operating colored touch screen.
Use "Start" to indicate the running status, there will be an abnormality indication to show the abnormality during the running process and the reset method will also be indicated so that customer is able to reset safely and quickly.

Safety detection

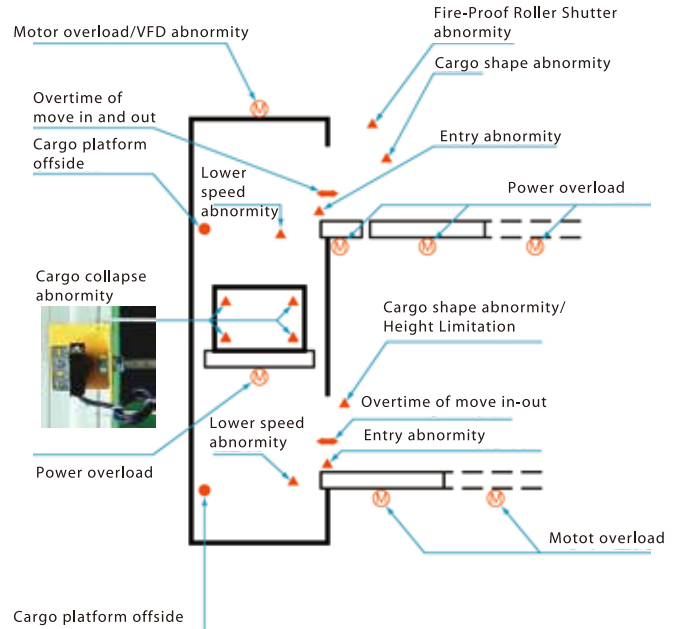

Safety Comparison with Cargo Elevator

Due to no requirement for a Machine room, So, it is easy in setting-up for both new constructing and existed buildings. Different from cargo elevator, It requires no construction confirmation and application for completion acceptance.

Extra constructions needed for existed building set up
(Except the construction carried out by our company)

- Openings construction.
- One-side power cabling construction
- Lifting material installation construction
- Pit construction(Occasion needed for Pit Construction)

Extra constructions needed for fire-proof area set up
(Except the construction carried out by our company)

- Fire-proof roller shutter door construction
- Fire-proof roller shutter door installation construction
- Hot air/Smog sensor photoeye installation construction
- Fire alarm device wiring construction

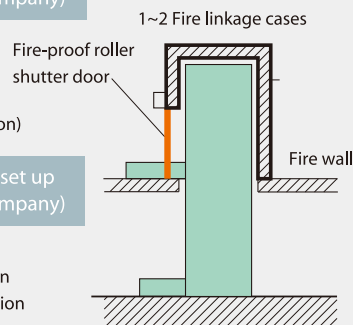

Fire Prevention Measures

Fire-proof roller shutter electric control (Optional)

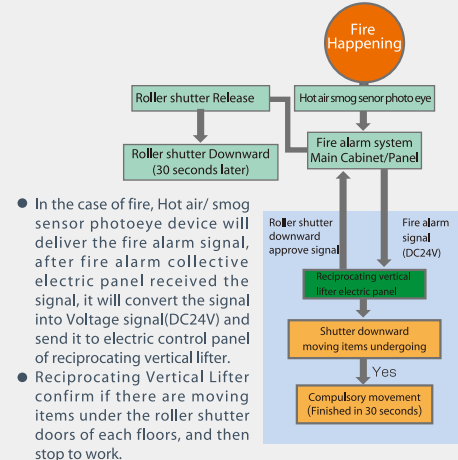

■ AEW Reciprocating Vertical Lifter



The standard model of AEW Reciprocating vertical lifter is suitable for conveying and handling Items between higher floors, It featured with high capacity and high efficiency. It utilizes Japanese HOKUSHO 's advanced technology and equipped with light profiles configuration. It is the best choice for energy-saving conveyings.

● High Conveying Capacity

Max conveying capacity is over 90 pallets/per hour,
Max conveying Speed is 90M/Per Minute.

● Dimension Diversification for handling items

Conveying Items Dimension range(LxW) is 800mm to 2900mm and Conveying height range is 150mm to 2400mm.

● Easy and Convenient Combination

Utilize Modular Design which is able To do the quick-assembly, easy and reasonable in transportation, usage And maintenance.

● Energy-saving and Environmental

Through material lightening and low-energy consumption method, it can realize the smooth performance by using low-power drives. Electric-saving assistant system is Optional.

■ Equipment structure

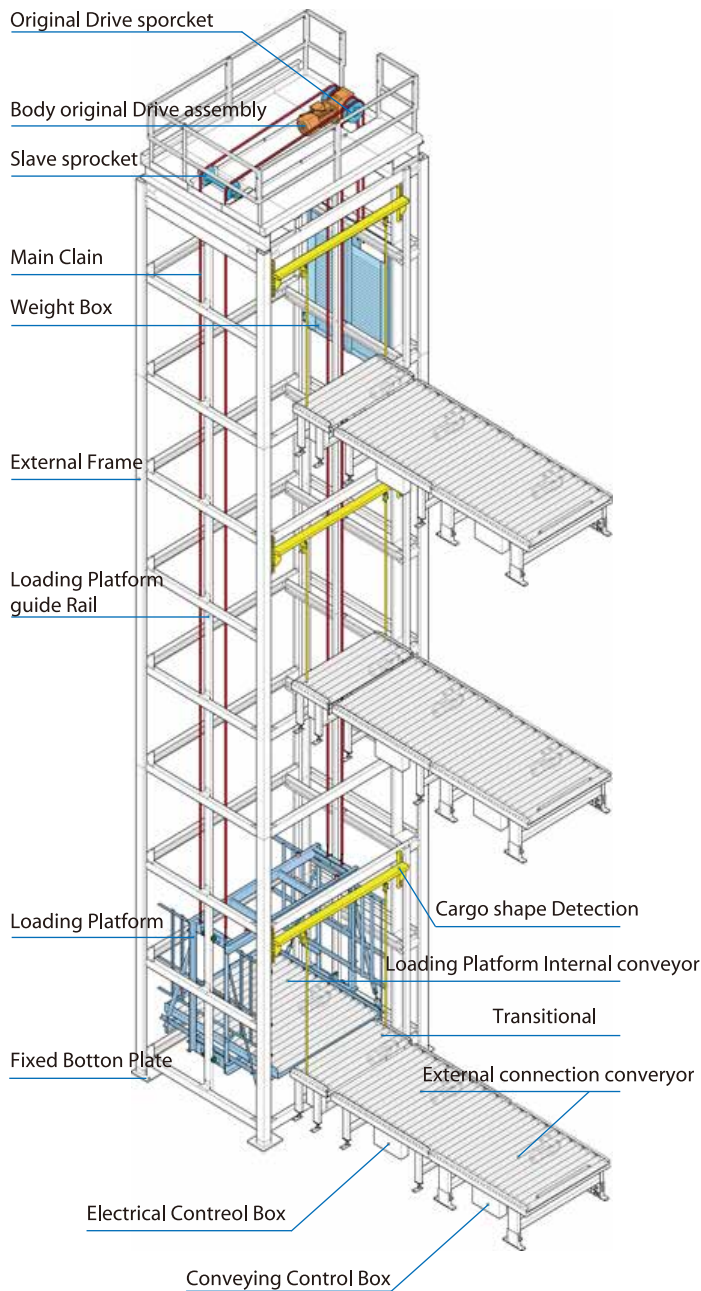

■ Basic Parameters

Product Features

- High conveying capacity
- Max conveying capacity is over 90 pallets/Per hour;
- ※ Lifting speed range:10,35,65,90(m/min)
- Diversification of Conveying items dimension
 - W 800 - 2900 (mm);
 - L 800 - 2900 (mm) ;
 - H 150 - 2400 (mm);
 (The above are increased by 100mm)

Equipment Main Parameters

- **Installation Environment:** Indoor -10~40 degree, No frozen, No vibration, Fire-proof, Roof height Is higher than the equipment height, Please consult for special environment.
- **Max conveying height :**40m
- **Max openings quantity:**12 (6 in single side)
- **Conveying items Dimension/Weight:**
 - ※ Max:W2900 X L2900 X H2400(mm)/2000kg
 - ※ Min: W800 X L800 X H150(mm)/15kg
- **Lifting Speed: 10,35,65,90(m/min)**
- **Equipment outer frame:** Steel wire mesh, Expanded mesh, Steel Plate
- **Standard Coating Color:** Damon product color series, HOKUSHO product series, customization.

Handling Direction

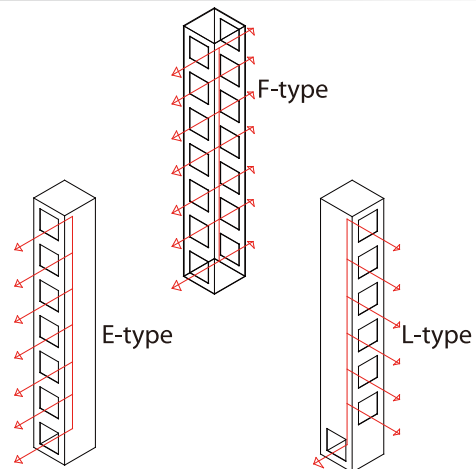

Equipment Dimension Reference Drawing

Set-up Layer

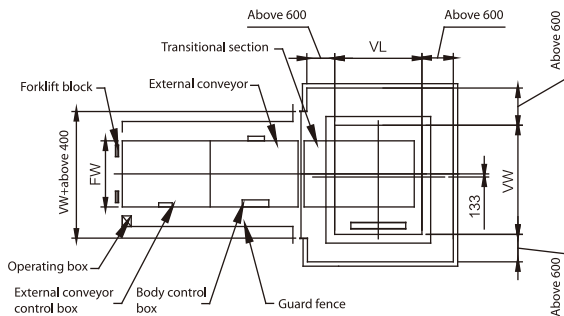

Top layer

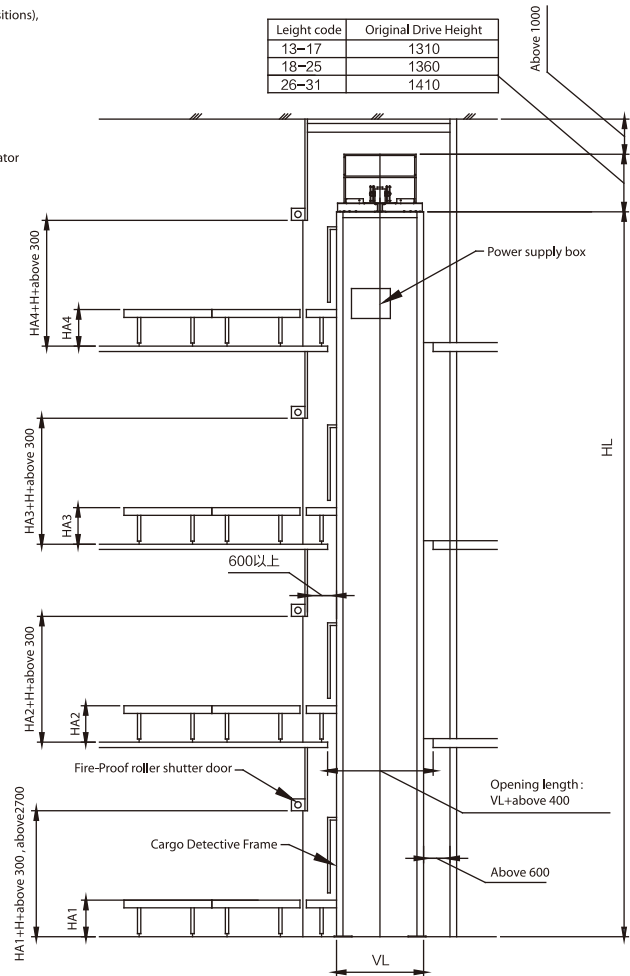
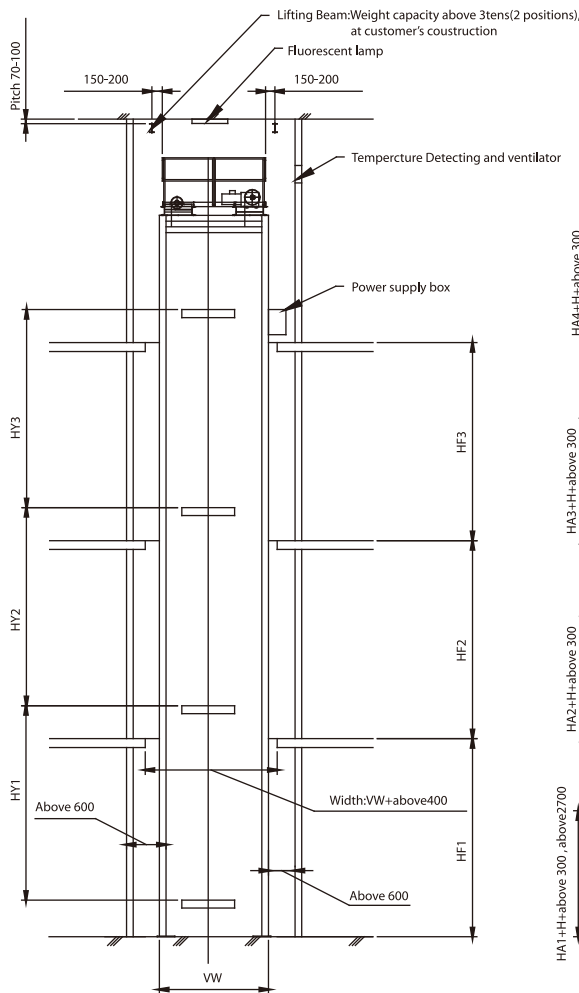
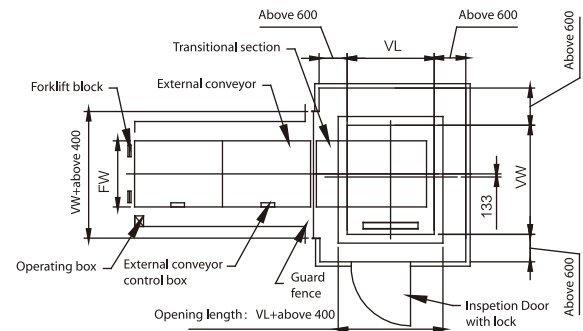

VW: Equipment opening width

VL: Equipment opening Length

HF: Equipment Length

HY: Stroke

HA: External conveyor

H: Max moving items height

FW: External conveyor width

Equipment Selection specification

(Piece/per hour)

Width Model	Opening (mm)	Max Item Width (mm)	Length code	Body deepness (mm)	Max Item Length (mm)	Max Item Height (mm)	Max Item weight (kg)
	VW	W		VL	L	H	
13	2280	1100	13	1696	1100	2400	2000
14	2380	1200	14	1791	1200		
15	2480	1300	15	1887	1300		
16	2580	1400	16	1982	1400		
17	2680	1500	17	2077	1500		
18	2780	1600	18	2172	1600		
19	2880	1700	19	2266	1700		
20	2980	1800	20	2363	1800		
21	3080	1900	21	2458	1900		
22	3180	2000	22	2553	2000		
23	3280	2100	23	2649	2100		
24	3380	2200	24	2744	2200		
25	3480	2300	25	2839	2300		
26	3580	2400	26	2934	2400		
27	3680	2500	27	3030	2500		
28	3780	2600	28	3125	2600		
29	3880	2700	29	3220	2700		
30	3980	2800	30	3315	2800		
31	4080	2900	31	3411	2900		

Basic Calculation Information

- 1.Special design is required when moving item width exceeds 1500mm,length exceeds 1300mm
- 2.Types with corresponding lower top roof and where a foundation pit required, please consult with us for details.
- 3.Please consult in the case if the handling is not to be carried out by blocked trolley.
- 4.Equipment height(mm)

$$HL = \left(\frac{HF1+HF2+HF3+HA4+H+620-12}{65} \text{INT} \right) \times 65 + 12$$

- Well deepness is required to add into the calculation
- Item H is start to calculation from 1500
- Max HL is 40m

Selection specification table

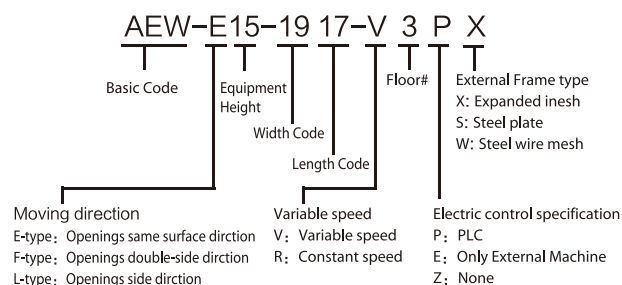

■ Application cases and photos

This type, after its launch, has been used in the projects of Wal-mart, Mitsui Chemical, Peace Bird Garment, Beyond Garment, Nonghua Logistics, Guoyao group, Tianjue wooden industry, etc.



■ Damon standard conveyor types

Pallet conveyors

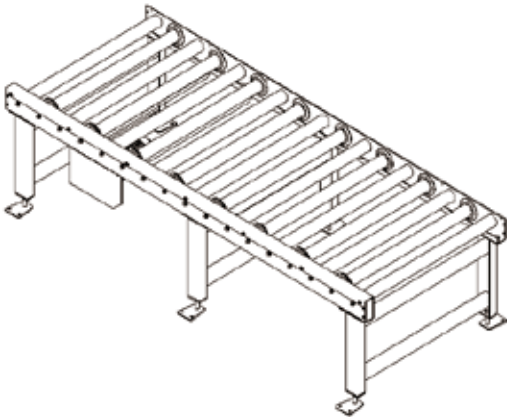

Technical parameters

Standard Rollers : Ø89Roller、Ø76Roller

Pitch of Rollers:143、174.8、190.5mm

EW:920、1020、1120 (Item Width+20, Min 920mm)

Conventional speed:12、16、18m/min, Max 20m/min

Motor power:0.37、0.55、0.75kw(SEW)

Chain:Donghua 10B-1

Min conveying surface:650mm

Max Weight Loading capacity: 2t

Chain conveyors

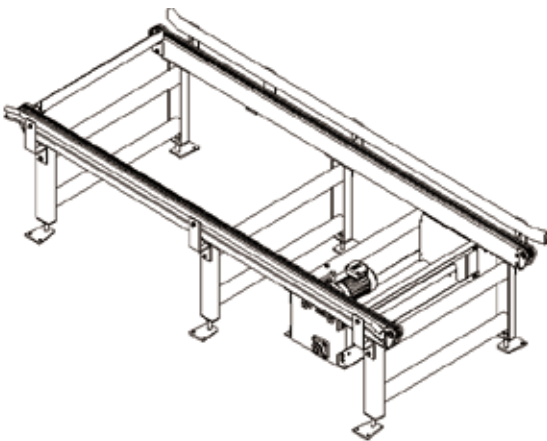

Technical parameters

Center Line Width:750、850、950 (pallet width-150, Min750mm)

Conventional Conveying:12,16,18m/min,Max 20m/min

Motor power:0.37、0.55、0.75kw (SEW)

Chain:Donghua10B-2

Min conveying surface:650mm

Max weight loading capacity:1.5t

Forks type roller conveyor

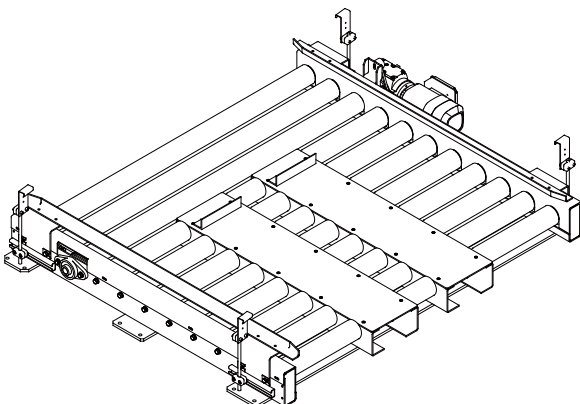

Technical parameters

Standard Rollers : Ø89Roller、Ø76Roller、Ø60Roller

Pitch of Rollers:143、174.8、190.5mm

EW:920、1020、1120 (Item Width+20, Min 920mm)

Conventional speed:12、16、18m/min, Max 20m/min

Motor power:0.37、0.55、0.75kw(SEW)

Chain:Donghua 10B-1

Min conveying surface:150mm

Max Weight Loading capacity: 2t

■ AENW Reciprocating Vertical Lifter



Watch the product introduction by scanning the code

AENW Reciprocating vertical lifter realized the arbitrary conveying between multi- floors, It meets the requirement on handling various kinds of pallet and trolley in different shapes. It is widely used in logistic center and production site.

● Easy in Operation

Random and quick conveying to any floor can be realized with only one button.

● Easy in Layout and maintenance

Utilize modular design which is able to do the quick-assembly, easy and reasonable in transportation, usage and maintenance.

● Automatic, Time-saving, High Efficiency

Handling items are able to move in and out Loading platform automatically, More efficient than the cargo elevators.

● Energy-saving and Environmental

Through material lightening and low-energy consumption structure method, it can realize smooth performance by using low-powerdrives. Electric-saving assistant system is optional.

■ AENW Equipment structure

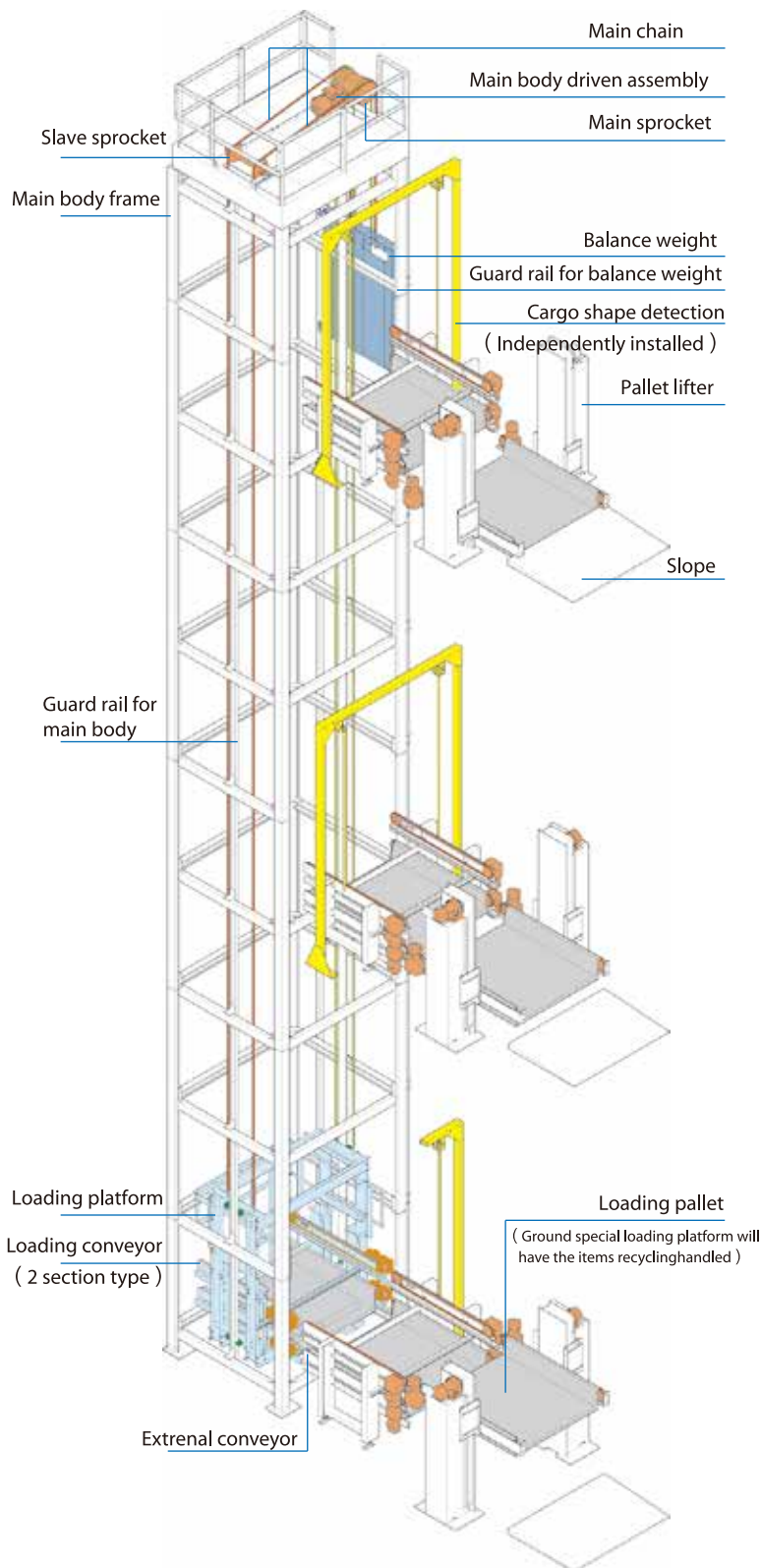

■ AENW Basic Parameters

Product Features

- **Various kinds of item conveying**
Pallet structure built inside the conveyor, trolley, bag-shaped item, pallet etc, can be conveyed.
- **Items smooth and stable move in & out**
Difference between ground and conveyor that has pallet structure inside is small, items can be smoothly and stably move in and out. The conveying will be more easier if 80mm pit applied.
- **Green and Environmental**
It can be equipped with VEAS electricity-saving Assistant system, It reduces the electricity consumption and CO2 emission by 25%.

Equipment Main Parameters

- **Installation environment:** indoor -10~40 degree, no frozen, no vibration, fire-proof, roof height is higher than the equipment height, please consult for special environment.
- **Max conveying height :** 40m
- **Max opening quantity:** 12 (6 in single side)
- **Conveying items dimension/weight:**
Max: w1500 x l1500 x h2400(mm)/1500kg
Min: w800 x l800 x h150(mm)/15kg
- **Lifting speed:** 10,35,65,90(m/min)
- **Equipment outer frame:** steel wire mesh, expanded mesh, steel plate.
- **Standard coating color:** Damon product color series, hokusho product series, customization.
- **Conveying opening direction:** E-type / F-type.

Handling Direction

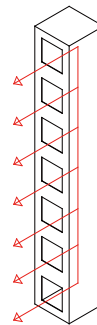

E-type

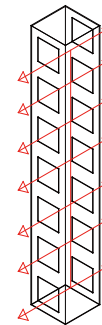

F-type

■ AENW equipment Dimension Reference Drawing

Set-up Layer

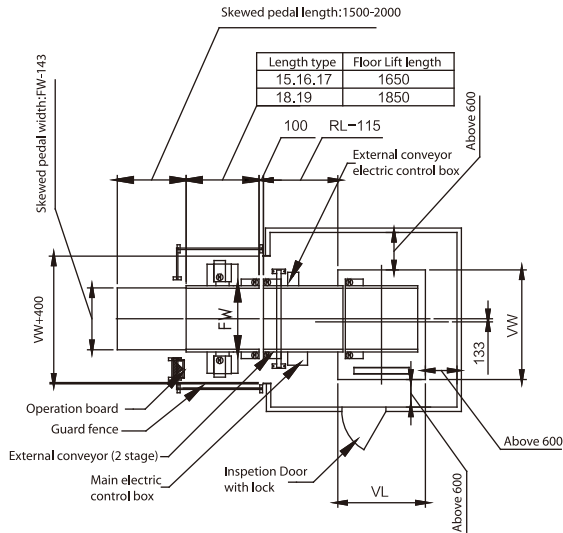

Top layer

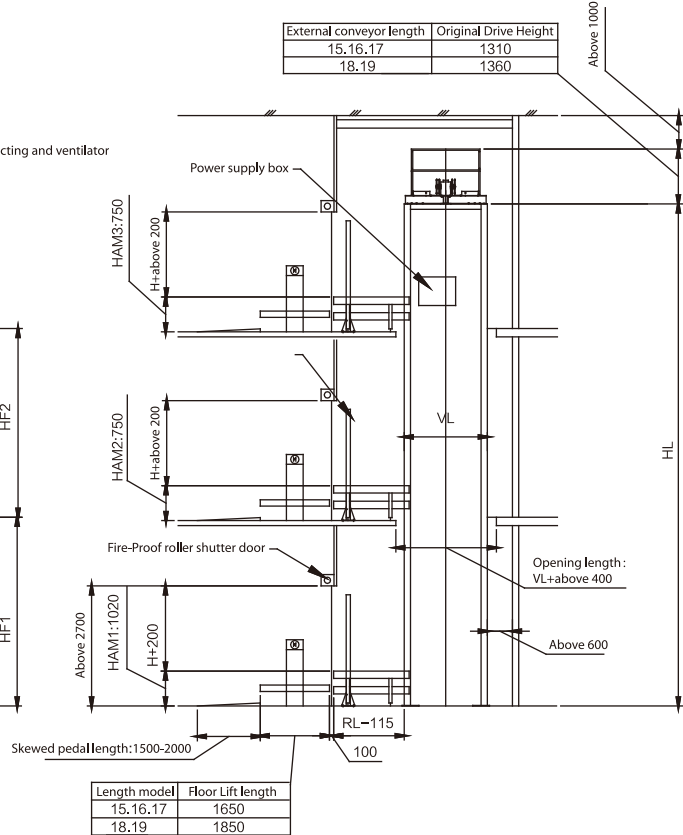
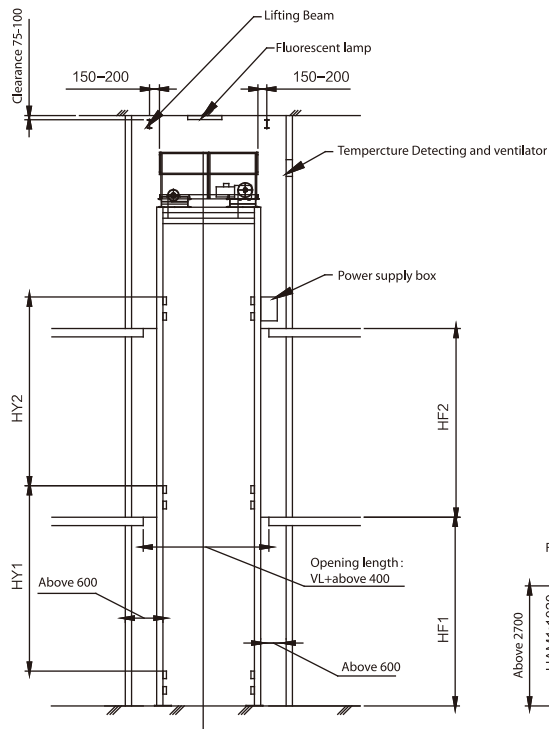
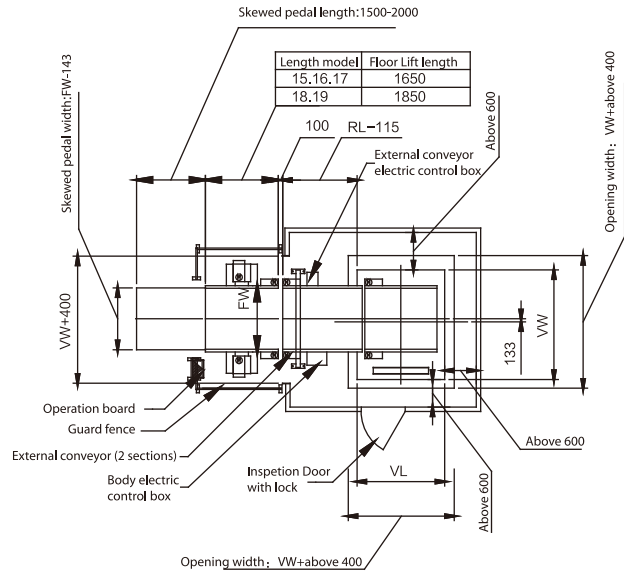

HL:Equipment height

HF:Body length

HY:Stroke height

HAM:Moving item transfer height

H:Max moving item height

FW:External conveyor width

RL:External conveyor width

Equipment Selection specification

(pcs/h.)

Model of equipment		Body dimension (mm)		Max. dimension for conveying goods (mm)			Weight	External conveyor	
Width code	Length code	width(VW)	Length(VL)	Width(W)	Length(L)	Height(H)		Width	Length
								FW	RL
15	15	2480	1887	1100	1100	2400	1500	1500	1700
	16		1982		1200				1800
	17		2077		1300				1900
	18		2172		1400				2000
	19		2268		1500				2100
16	15	2580	1887	1200	1100	2400	1500	1600	1700
	16		1982		1200				1800
	17		2077		1300				1900
	18		2172		1400				2000
	19		2268		1500				2100
17	15	2680	1887	1300	1100	2400	1500	1700	1700
	16		1982		1200				1800
	17		2077		1300				1900
	18		2172		1400				2000
	19		2268		1500				2100
18	15	2780	1887	1400	1100	2400	1500	1800	1700
	16		1982		1200				1800
	17		2077		1300				1900
	18		2172		1400				2000
	19		2268		1500				2100
19	15	2880	1887	1500	1100	2400	1500	1900	1700
	16		1982		1200				1800
	17		2077		1300				1900
	18		2172		1400				2000
	19		2268		1500				2100

Basic Calculation Information

- 1.Special design is required when moving item width exceeds 1500mm,length exceeds 1300mm
- 2.Types with corresponding lower top roof and where a foundation pit required, please consult with us for details.
- 3.Please consult in the case if the handling is not to be carried out by blocked trolley.
- 4.Equipment height(mm)

$$HL = \left(\frac{HF1+HF2+HF3+HA4+H+620-12}{65} \text{INT} \right) \times 65 + 12$$

- Well deepness is required to add into the calculation
- Item H is start to calculation from 1500
- Max HL is 40m

Selection specification table

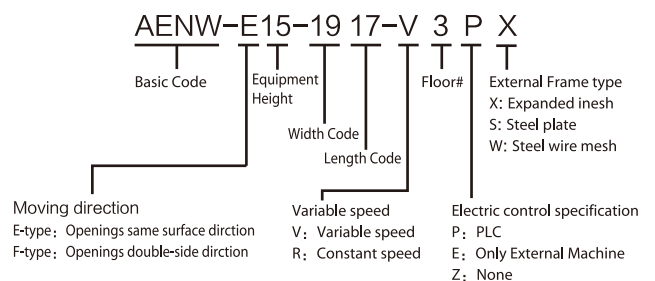

■ AEEW reciprocating vertical lift



Watch the product introduction by scanning the code

AEEW reciprocating vertical lift achieve for exchange pallet in different floor, and space-saving at the same time. In front of body equipped with lifting connection device. Efficient and space saving. Build with slope or 80mm foundation pit, not only trolley can enter in, and also pallet can enter by hydraulic trolley and forklift.

● Convey kinds of different products

Because it can convey products to the floor pallet, so it's not only a pallet, But like a logistic trolley. So like bag goods and all the products, which can keep shape, not easy to topple down products can convey by it.

● Efficiency

Vertical conveyor with vertical lifting speed 90m/min. Moving distance from the top to the bottom is 4m, one hour can running 120 cycle, which with high efficiency.

● Safety design

As a standard device, design with neighbor rolling door and other protecting device to protect operator safe from kinds of dangers. At the same time for protecting good, we equipped with extraordinary case inspection device.

● Simple design & economical and practical

All structure can design, whatever new one or old one. It has no necessary to design foundation pit. Also the difference from elevator is that the lift don't need to get permission from government. So it saved security inspection every year, economical and practical.

Equipment structure

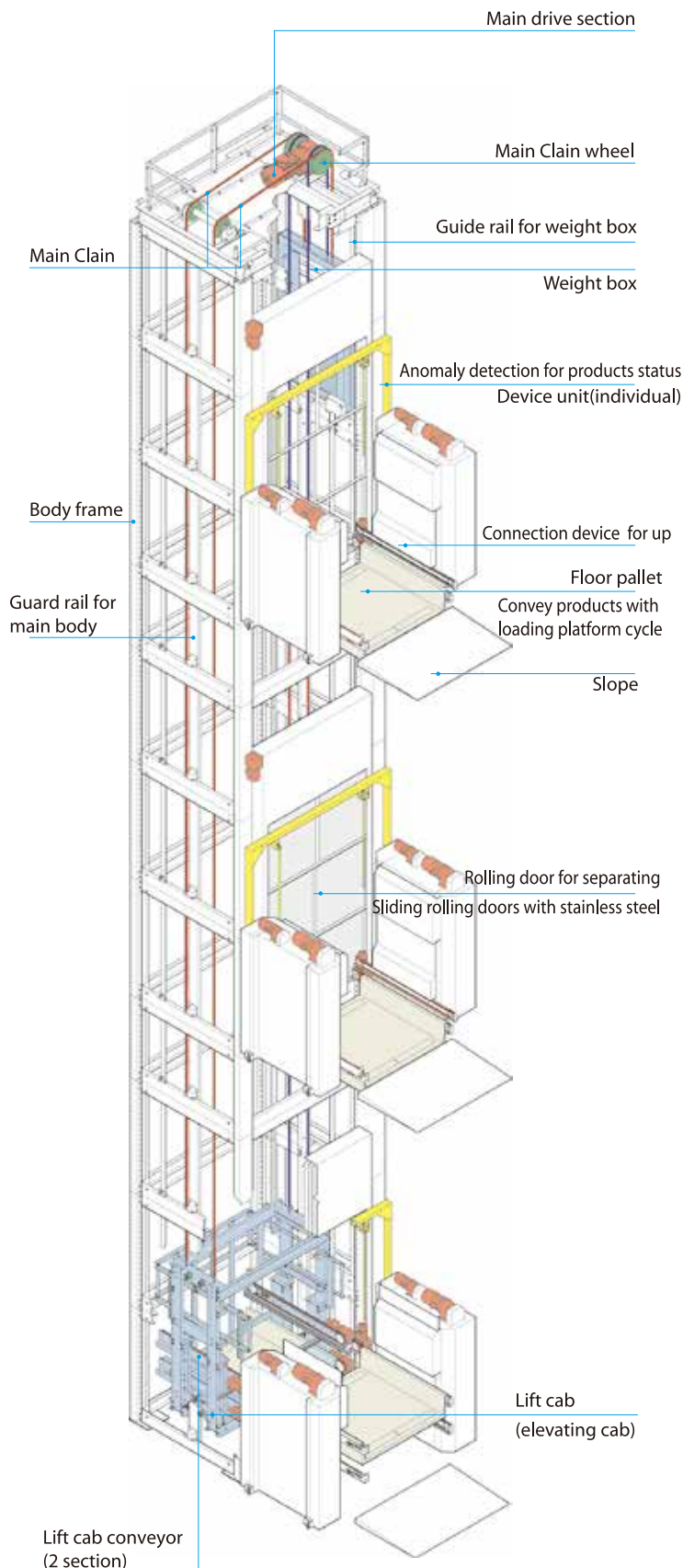

Basic Parameters

Product Features

● Kinds of products to convey

Conveyor enter with pallet structure, so all products can convey like trolley, bag goods, pallet and others.

● Stably in transportation

Small drop height between underground and build-in pallet, so products can stable transportation. If excavate 80mm foundation pit, will be more convenient for conveying.

● Environmental

May equip with VEAS auxiliary electrical-saving system, consumed power and CO2 will reduce 25%.

Equipment Main Parameters

● **Installation environment:** indoor temperature -10-40℃, no icing, no vibration, fire protection, height of roof higher than equipment, special environment consult us.

● **Max conveying height:** 40m

● **Max opening quantity:** 12 pcs(6pcs one side)

● **Products dimension/weight :**

Max: W1500*L1300*H2400 (mm)/1500kg

Min: W800*L800*H150 (mm)/15kg

● **Elevating speed:** 10, 35, 65, 90 (m/min.)

● **Type of frame:** steel screen, steel, barbed wire, acrylic board.

● **Standard painting color:** product color of Damon series, product color of north business, customized color.

● **Conveying Opening direction:** E-type/F-type

Handling Direction

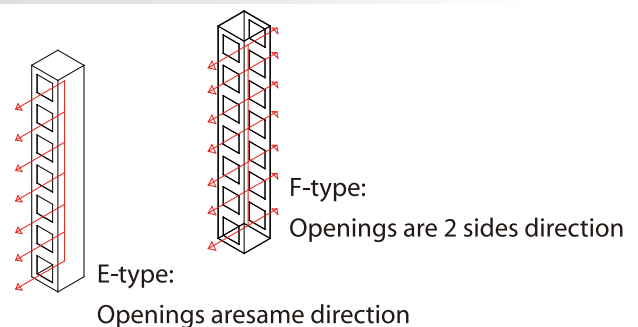

■ AEW Equipment Dimension Reference Drawing

Set-up Layer

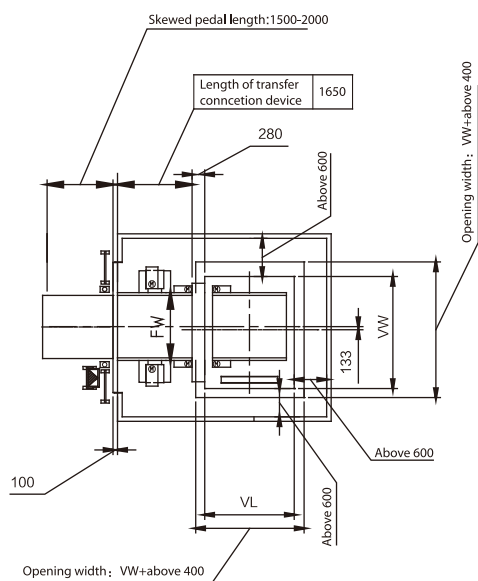

Top layer

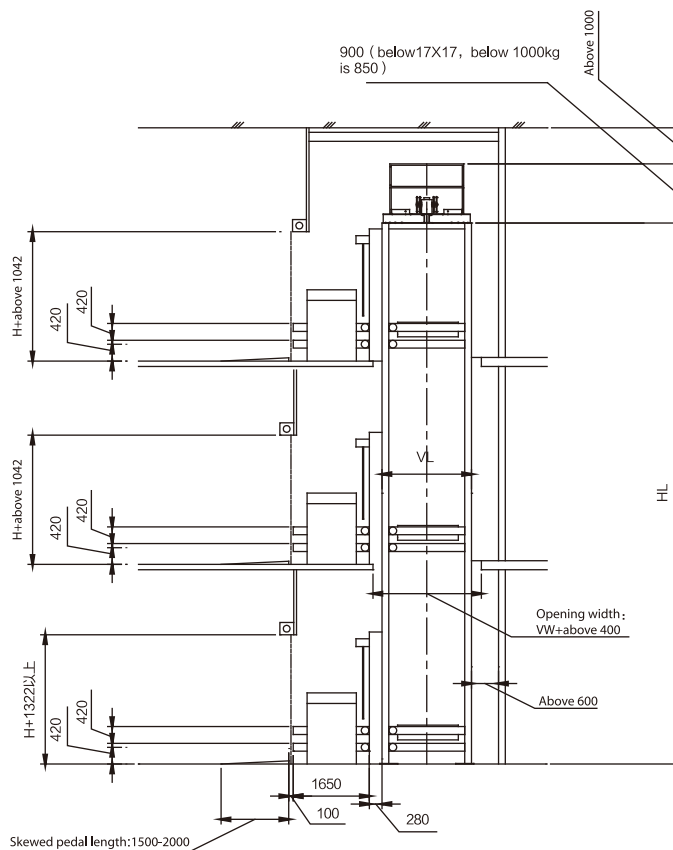
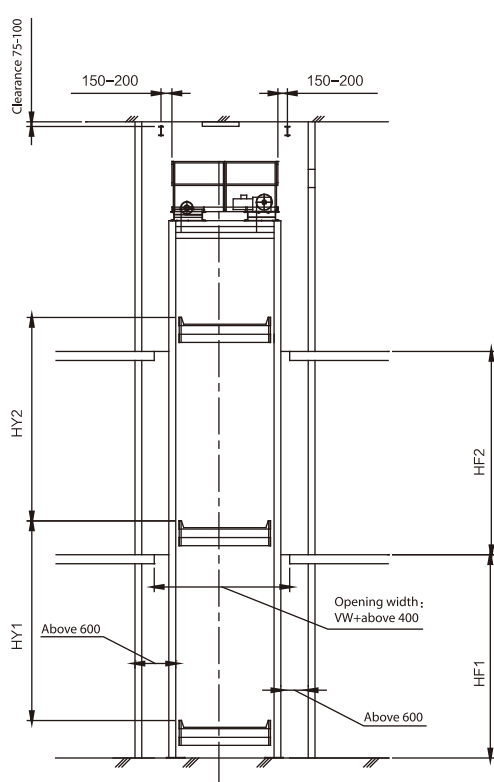
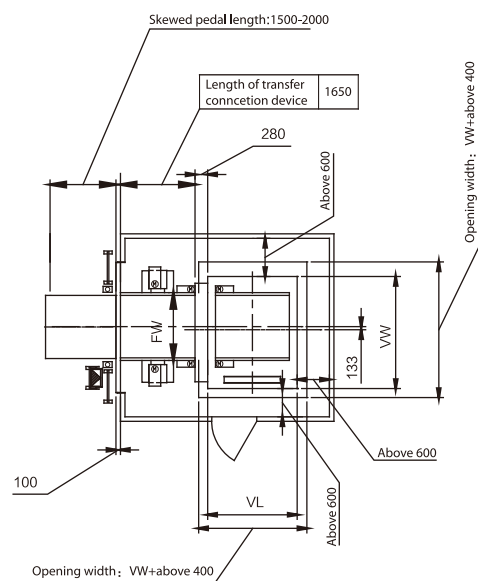

■ AEEW capacity table

(Moving cycle/h)

Max. height of goods (mm)	37	60	90
Lift height(M)			
3	106	120	124
4	96	112	121
5	88	105	116
6	81	99	111
7	75	94	106
8	70	89	103
10	62	81	95
12	55	74	89
15	48	66	80
18	42	59	74
20	39	55	70
22	36	52	66
25	33	48	61
30	30	44	56
35	27	41	52

■ Selection specification table

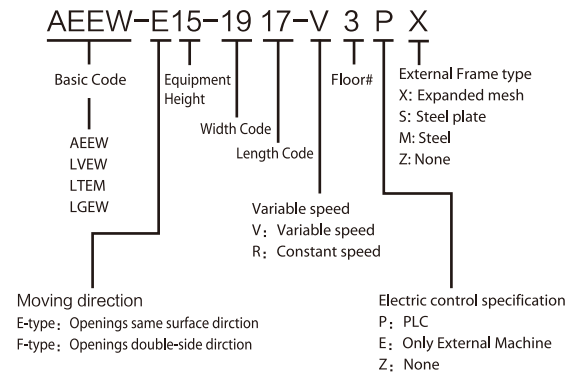

■ AEEW dimension diagram

(pcs/h)

Body dimension specification		Body dimension		Max dimension of goods (range)			
Opening	Depth	Opening mm	Depth mm	Opening mm	Depth mm	Height mm	Weight (kg)
		VW	VL	W	L	H	
15	15	2480	1887	1100	1100	2400	1500
	16		1982		1200		
	17		2077		1300		
16	15	2580	1887	1200	1100	2400	1500
	16		1982		1200		
	17		2077		1300		
17	15	2680	1887	1300	1100	2400	1500
	16		1982		1200		
	17		2077		1300		
18	15	2780	1887	1400	1100	2400	1500
	16		1982		1200		
	17		2077		1300		
19	15	2880	1887	1500	1100	2400	1500
	16		1982		1200		
	17		2077		1300		

Max dimension of goods.

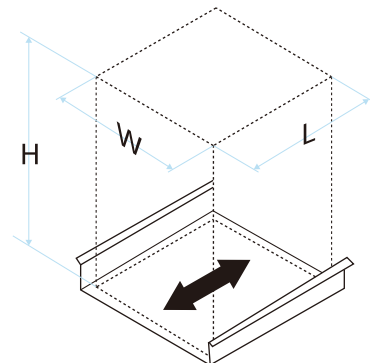

■ AEW operation diagram

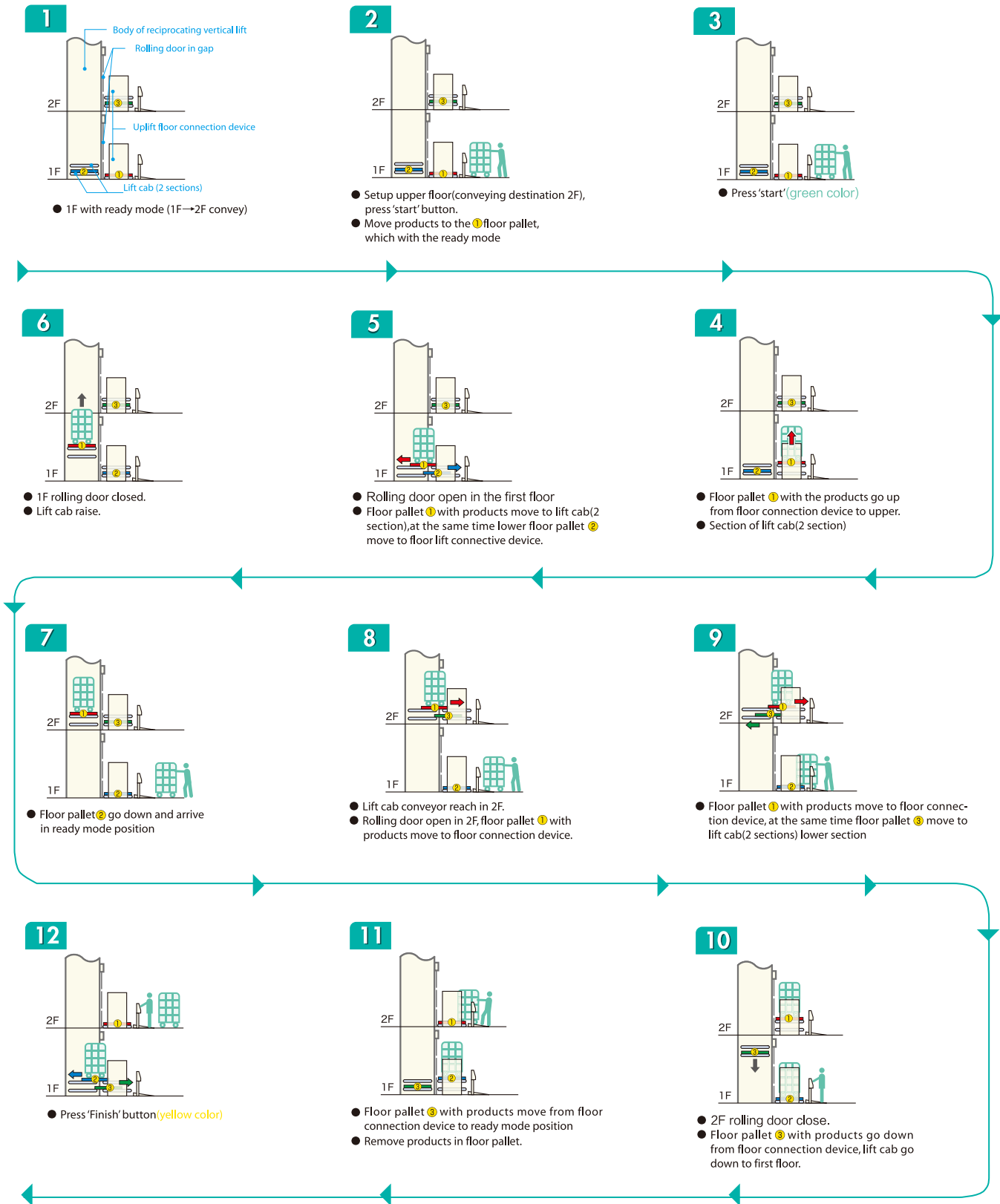

■ AEW operation diagram

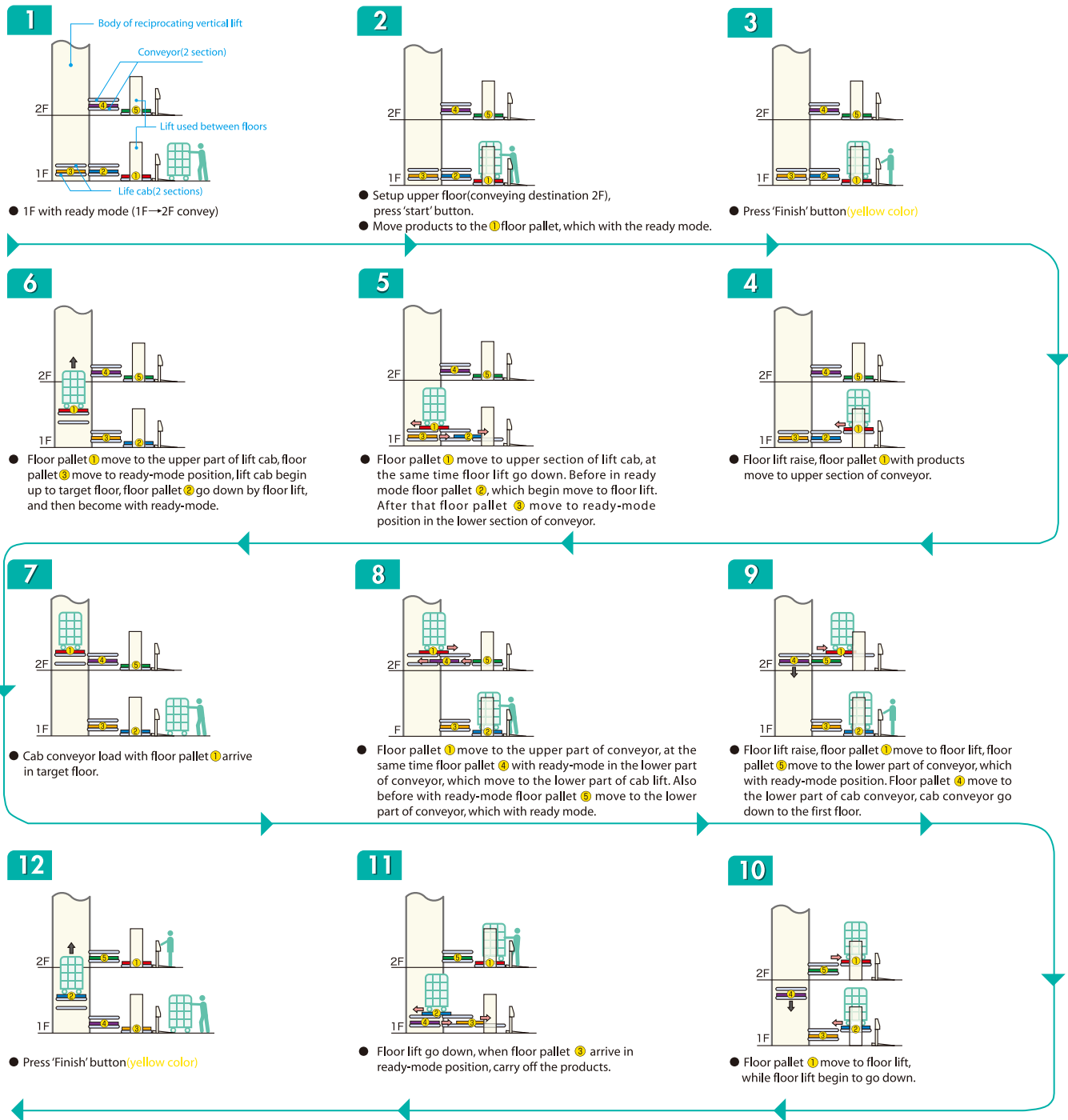

Reserve-type

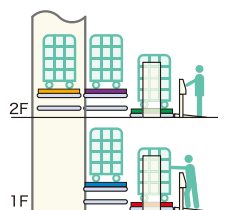

Full loading stopped state diagram
(1F→2F place for conveying)

It can store 5 pallets Max.

Note: if not press 'finish' button in 2F, floor pallet with products will not move from conveyor position to ready-mode position.

■ AEW and AENW project photo



This type, after its launch, has been used in the projects of JD Logistics Center, Gree, KWE Global Logistics Partner, etc.



Operating principle

When loading platform running down, the rest potential energy can exchange to electrical power (renewable energy), charge to the accumulator.

When loading platform running up, accumulator device can charge to lift motor, so can save power.

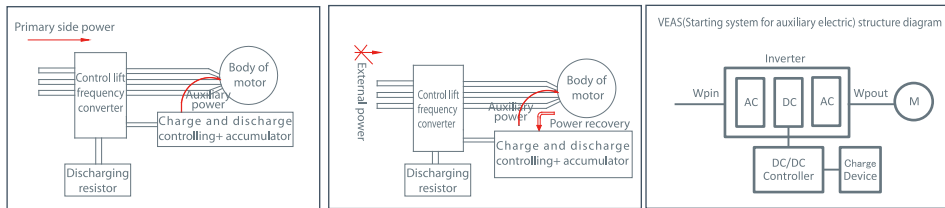

Power saving auxiliary system

It's perfect embodiment of power saving

With new energy-saving technic from Japanese HOKUSHO, use with VEAS energy-saving system. Auxiliary power-saving system can supply 1/3 power for starting the device, amount for electric supply unit decrease 40% Max, consuming electric and CO2 can decrease 25% Max.

Characteristic of this system

Energy saving

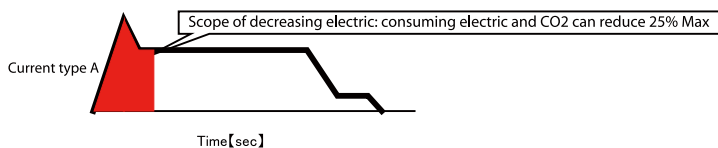
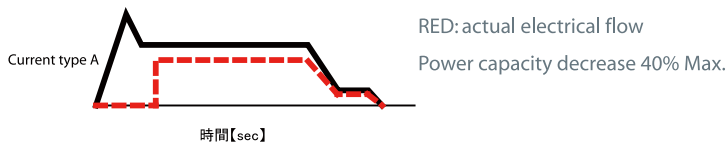

High Cost-Effective

Electrical power in starting moment can save 50%, electric amount can decrease 40% Max.. Because of starting energy decreased, so it can save costs of power device.

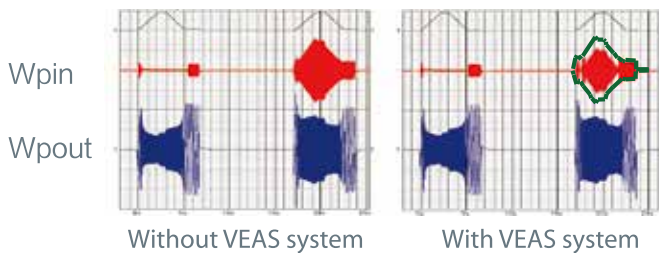

High security

Control unit in electrical storage device can check inner charging voltage, in case of damage of over charged.

Control unit have over-thermal protection, when charging device overheated, it will alarm.

In an emergency, charging device and frequency converter will cut off, frequency converter will in isolated operation

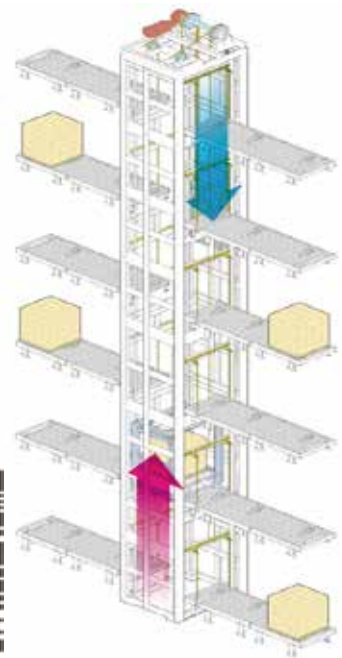

Watch the Green Environment Protection & Energy Saving Mystery of the Vertical Conveying Product by scanning the code.

VEAS(auxiliary system for starting electric) measured data

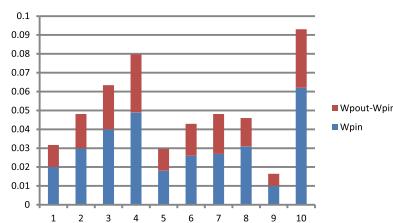

	Assist
1	36.9%
2	37.6%
3	36.9%
4	38.6%
5	39.4%
6	39.4%
7	43.9%
8	32.6%
9	39.0%
10	33.3%

Display interface with VEAS system



External electric in charging



External electric in running



VEAS accumulator in dischargin



VEAS accumulator in chargin

■ VEF continous vertical lift



VEF is the classical model of continous vertical lift and it almost suitable for a variety of vertical transmission situations. It adopted the advanced technology of Japan HOKUSHO. Furthermore, It is made in local and high performance-cost ratio with it.

● Easy and Convenient Combination

Through the system that combined by multifarious conveying equipments. It is easy to set up a Three-dimensional continuous conveying line to achieve high efficiency tasks.

● Good universality and wide application

As the classical system of vertical transmission. It can satisfy the needs of logistics vertical transport. In warehouse, the center of distribution and the center of logistics are applied widely.

● Easy in layout and maintenance

Utilize modular Design which is able to do the quick-assembly, easy and Reasonable in transportation, usage and maintenance.

● Energy-saving and Environmental

Through material lightening, it can realize smooth performance by using Low-power drives.



Watch the product
introduction
by scanning the code

■ Z-type equipment structure

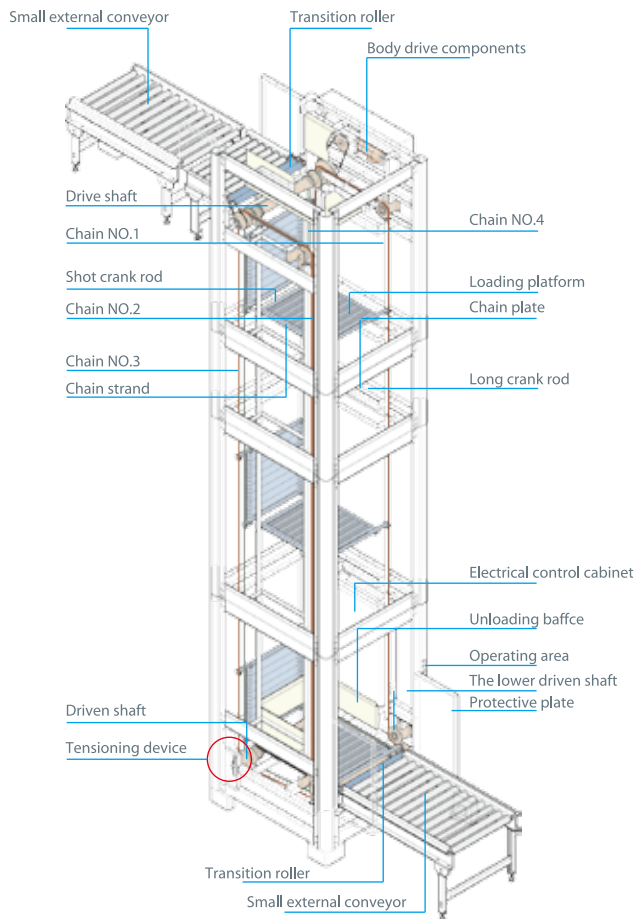

■ C-type equipment structure

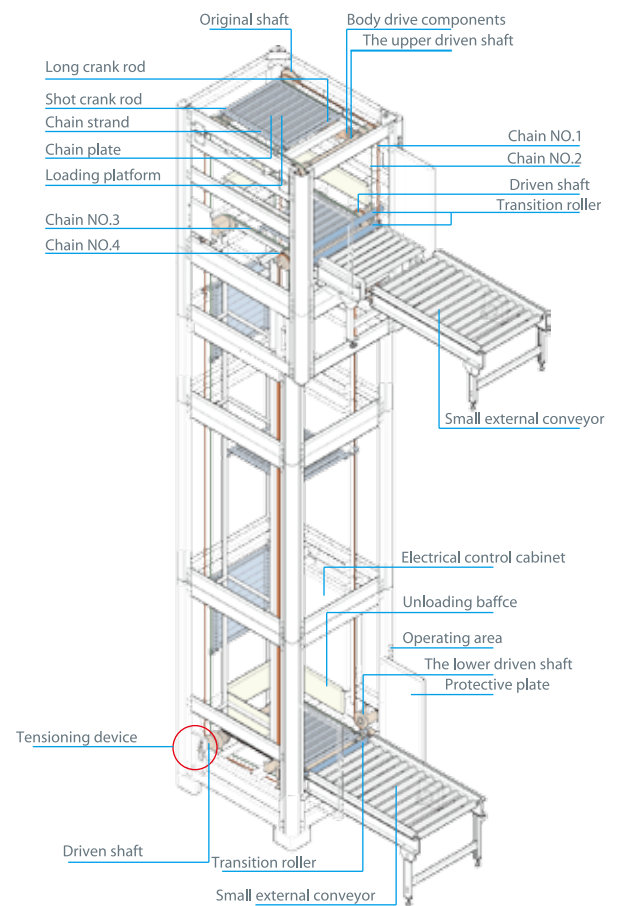

■ Entrance form

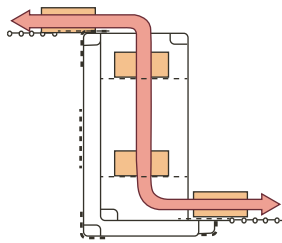

Z type: Opening in opposite direction

The entrance formed with front and back. it is disposed in front of the building, it can be used flexibly in the back of the upper floors.

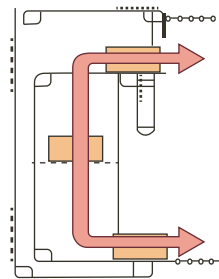

C type: Opening are in same direction

the entrance and outlet on the same surface. it is suitable for repeated handling with the state of against the wall. Its handling capacity is 1/2 of the form Z.

VEF Equipment Dimension Reference Drawing

VEF11-Z

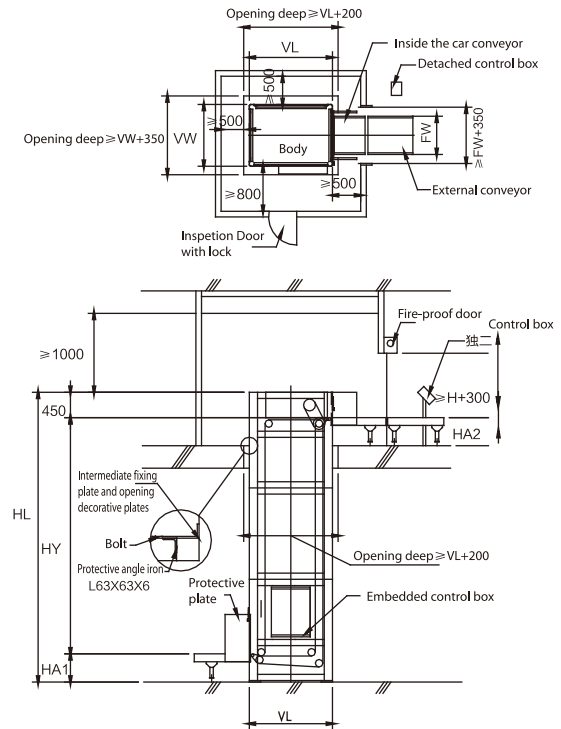
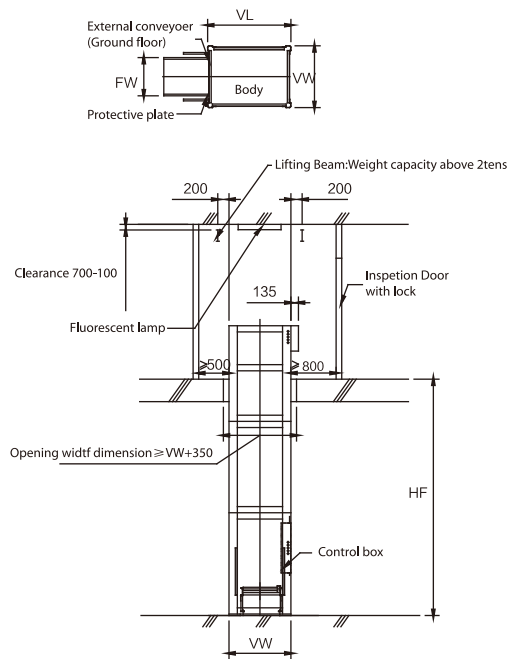

VEF11-C

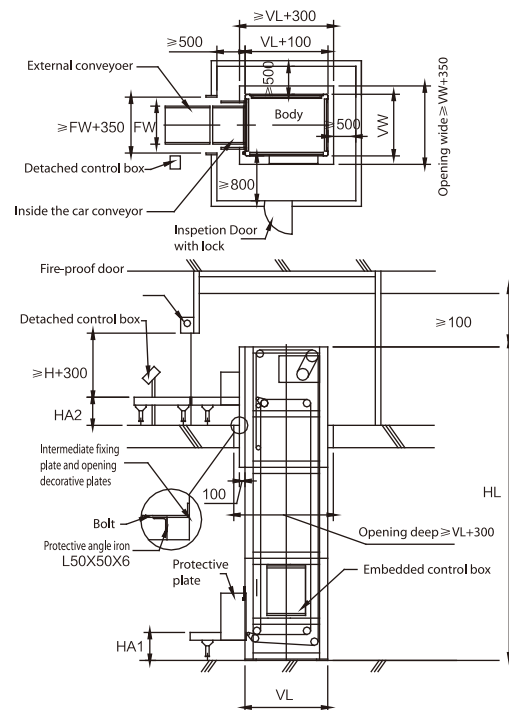
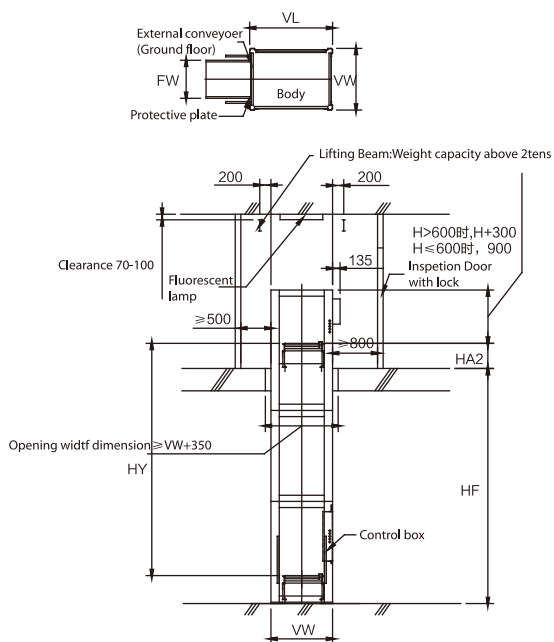

VW: Body width	HL: Equipment height	HL: Loading height
VL: Body length	HF: Body length	HF: External conveyor width
	HY: lift	HY: Conveyor surface height

■ Project photo



This type, after its launch, has been used in the projects of JD.COM, GP Corp, JINFEI HOLDING GROUP, Gree, PEACE BIRD etc.



To :	Fax No :
CC :	Date :
From:	Page _____ Total _____ Pages

AEW continuous vertical lift

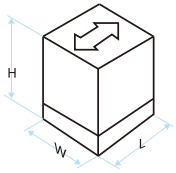
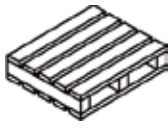
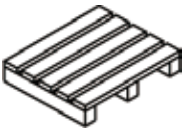
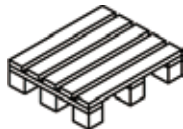
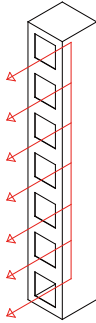
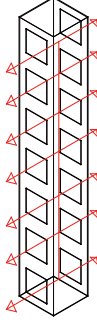
1.Pallet type	TypeA	TypeB	TypeC					
								
2.Conveying items Dimension/Weight	Max	W	x	L	x	H	mm	Weight Kg
	Min	W	x	L	x	H	mm	Weight Kg
3.Lifting efficiency	() Parts/h							
4.Operation hours	() h/day							
5.Conveying opening direction	E type: opening are same direction				F type : opening two direction			
								
6.Use the form	The upper and lower conveyor		Dedicated rise		Fall special			
7.Floor level height	1F ____ — 2F							
	3F ____ — 4F							
	5F ____ — 6F							
8.Conveying surface height	1F ____ — 2F							
	3F ____ — 4F							
	5F ____ — 6F							
9.Protective	A:Steel wire mesh		B:Expanded mesh		C:Steel Plate		D:Others	
10.Coating Color								
11.Installation site	A: Indoor				B: Outdoor			
12.Quantity								
13.Custom information	Contacts							
	Company Name							
	Installation Address							



To :	Fax No :
CC :	Date :
From:	Page _____ Total _____ Pages

AENW/AEEW continuous vertical lift

1.Pallet type	TypeA		TypeB					
2.Conveying items Dimension/Weight	Max	W	×	L	×	H		Weight Kg
			mm		mm		mm	
	Min	W	×	L	×	H		Weight Kg
			mm		mm		mm	
3.Lifting efficiency	() Parts/h							
4.Operation hours	() h/day							
5.Conveying opening direction	Etype: opening are same direction				F Type: opening two direction			
6.Use the form	The upper and lower conveyor		Dedicated rise		Fall special			
7.Floor level height	1F ____ — 2F							
	3F ____ — 4F							
	5F ____ — 6F							
8.Conveying surface height	1F ____ — 2F							
	3F ____ — 4F							
	5F ____ — 6F							
9.Protective	A:Steel wire mesh		B:Expanded mesh		C:Steel Plate		D:Others	
10.Coating Color								
11.Installation site	A: Indoor				B: Outdoor			

To :	Fax No :
CC :	Date :
From:	Page _____ Total _____ Pages

VEFcontinuous vertical lift

1.Types of conveyed goods	 <input type="checkbox"/> Cartons  <input type="checkbox"/> Plastic containers  <input type="checkbox"/> Sacks
2.Conveying items Dimension/Weight	Max: W _____ xL _____ xH _____ weight: _____ kg Min: W _____ xL _____ xH _____ weight: _____ kg
3.Lifting efficiency	_____ Parts/h
4.Operation hours	_____ h/day
5.Conveying opening direction	Gateway Z Types <input type="checkbox"/> Gateway C Types <input type="checkbox"/>
6.Use the form	<input type="checkbox"/> The upper and lower conveyor <input type="checkbox"/> Dedicated rise <input type="checkbox"/> Fall special
7.Floor level height	_____ mm
8.Conveying surface height	Entrance conveying surface height _____ mm Exit conveying surface height _____ mm
9.Protective	<input type="checkbox"/> Metal mesh <input type="checkbox"/> Plate <input type="checkbox"/> Plexiglass
10.Coating Color	<input type="checkbox"/> Indoor <input type="checkbox"/> Outdoor
11.Installation site	
12.Quantity	Custom name:
	Demand:
13.Custom information	

